

Genset
Model: **YXP600RSC**

Enclosed set

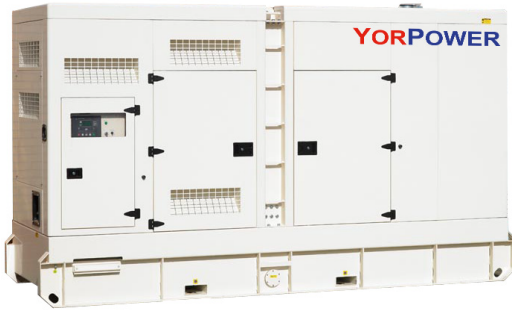

Open set



Frequency	Phases	Power factor	Prime output	Standby output
50Hz	3	0.8	600 kVA / 480 kW	660 kVA / 528 kW

Ratings

- Prime output: This rating is applicable for supplying continuous electrical power at variable load. There is no limitation to the annual hours of operation and this model can supply 10% overload power for 1 hour in 12 hours.
- Standby output: This rating is applicable for supplying electrical power (at variable load) in the event of a utility power failure. No overload is permitted on these ratings.
- Standard reference conditions: 25°C, 100m A.S.L., 30% relative humidity.

Design features

- High quality assembly, providing stiffness and low vibration.
- Powder coated steel. Corrosion and scratch resistant.
- Compact and long service life.
- Wiring and connectors with double protection.
- Protection guards in radiator and high voltage parts.
- Full 12 month YorPower Warranty.

Design standards

- CE marking.
- ISO8528-1995.
- GB/T2820-1997.
- ISO 9001:2008 Registered Company.

Configuration

- 4-Stroke water-cooled diesel engine.
- Industrial silencer.
- Coolant recovery tank.
- Single bearing, 4 pole brushless alternator.
- Anti vibration mountings.
- Integral fuel tank with fully bounded base protection.
- Fuel level sensor.
- Auto start control system with electronic digital control module DSE7420 as standard.
- Output circuit breaker.
- Emergency stop button.
- High engine temperature and low oil pressure shutdown system.
- 24V starter battery with leads and switch.

Acoustic canopy features

- Water and dust proof design.
- Door locks.
- High quality sound absorbing and fire retardant inner material.
- Lifting lugs.
- Forklift holes in base.

** The images above are for illustration purposes only.

Engine data

Engine brand	Perkins	Total coolant capacity	61 Litres
Engine model	2806C-E18TAG1A	Total lub oil capacity	62 Litres
Engine Speed	1500 RPM	Cooling air flow	702 m ³ /min
Number of cylinders	6	Exhaust gas flow (max)	104 m ³ /min
Aspiration	Turbocharged & Aftercooled	Exhaust gas temperature (max)	571 °C
Combustion system	Direct injection	Fuel cons. @ 100% Standby load	134 l/hr
Displacement	18.1 Litres	Fuel cons. @ 100% Prime load	123 l/hr
Governor type	Electronic	Fuel cons. @ 75% Prime load	90 l/hr
Cooling system	Water cooled	Fuel cons. @ 50% Prime load	61 l/hr

Alternator data

Alternator brand	Leroy Somer	Number of wires	12
Alternator model	LSA47.2L9	AVR model	R 250
Excitation	Self excited	Voltage regulation	± 0.5%
Insulation class	H	Total Harmonic distortion	< 2% on load
Drip proof protection	IP23	Telephone interference	TIF < 50%
Winding pitch	2/3 (N° 6 or N° 6S)	Flanges and shield	Cast iron

Enclosed set data

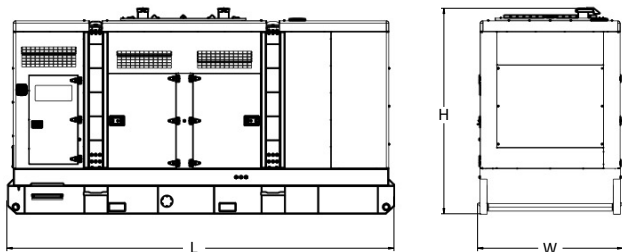

L x W x H (mm)	Weight	Fuel tank	Noise@7m
4692 x 1700 x 2488	6330 kg	945 Litres	76 db

Open set data

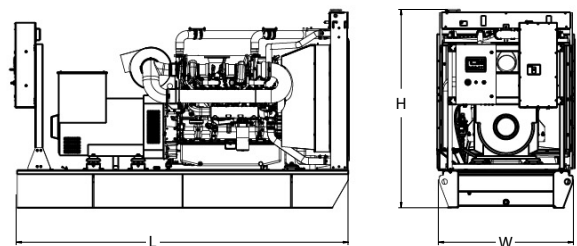

L x W x H (mm)	Weight	Fuel tank	Noise@7m
3800 x 1536 x 2204	4662 kg	1100 Litres	115 db

** Due to constant innovation, design and specifications are subject to change without notice. All weights, dimensions and noise levels are subject to a 10% tolerance.

Distributor Address:

YORPOWER

YorPower Ltd,
Electricity Building, Unit 2 Hurricane Close,
Sherburn in Elmet, Leeds LS25 6PB, UK
T : +44 (0)1977 688155
E: sales@yorpower.com
www.yorpower.com